

A

B

C

D

E

F

G

H

I

J

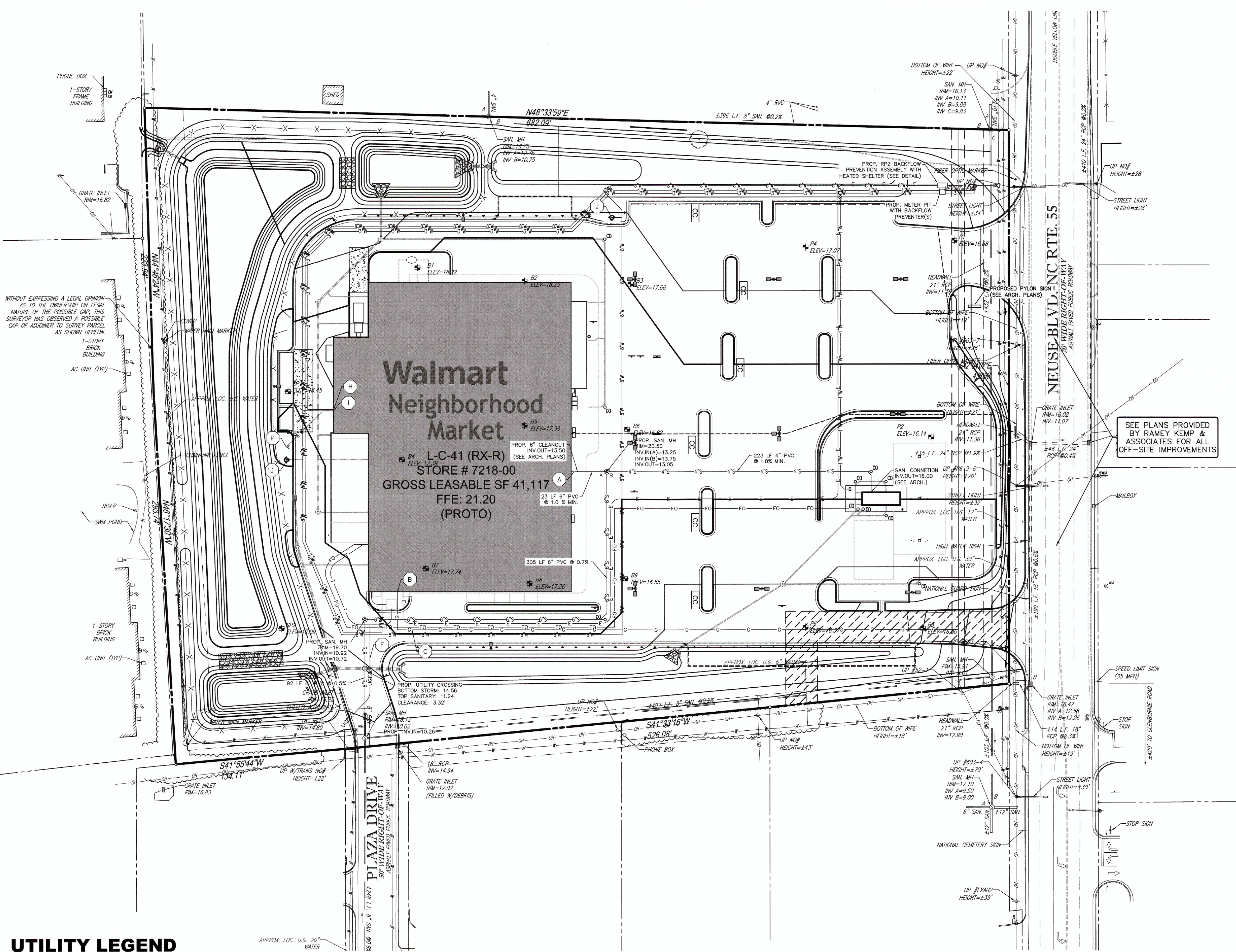

UTILITY LEGEND

- A 6" SANITARY SEWER LATERAL AT MINIMUM 1.0% SLOPE. COORDINATE WITH ARCHITECTURAL PLANS.
- B GAS ENTRY WITH GAS METER. CONTRACTOR RESPONSIBLE FOR INSTALLING PIPE BOLLARD PROTECTION AT METER. CONTRACTOR SHALL COORDINATE WITH GAS COMPANY FOR TYPING OF INDIVIDUAL METER.
- C CONTRACTOR IS RESPONSIBLE FOR COORDINATION WITH GAS COMPANY REGARDING THE SIZE AND INSTALLATION OF GAS SERVICE LINE.
- D 1" PVC CONDUIT FOR TAMPER SWITCH. - NOT USED
- E PROPOSED LOCATION OF TRANSFORMER PAD. CONTRACTOR TO VERIFY EXACT LOCATION AND SIZE WITH POWER COMPANY PRIOR TO INSTALLATION. CONTRACTOR SHALL BE RESPONSIBLE FOR INSTALLATION OF CONCRETE PAD, CONDUIT AND PIPE BOLLARDS AS REQUIRED BY THE ELECTRIC COMPANY. CONTRACTOR SHALL COORDINATE SAID WORK WITH THE ELECTRIC COMPANY. FINAL LOCATION OF TRANSFORMER AND BOLLARD CANNOT CONFLICT WITH TRUCK ACCESS TO DOCK DOOR.
- F UNDERGROUND ELECTRIC AND TELEPHONE FROM POLE TO BUILDING TO BE EXTENDED BY TELEPHONE COMPANY.

- G CONTRACTOR IS RESPONSIBLE TO COORDINATE WITH THE TELEPHONE COMPANY FOR THE INSTALLATION OF OVERHEAD TELEPHONE LINES. CONTRACTOR SHALL COORDINATE THE TYPING OF INDIVIDUAL METERS WITH THE ELECTRIC COMPANY. CONTRACTOR TO COORDINATE WITH TELEPHONE COMPANY TO INSURE PROPER SEPARATION BETWEEN OVERHEAD LINES AND LIGHT POLES. - NOT USED
- H 3" DOMESTIC WATER LINE ENTRY WITH METER PER ANY TOWN PUBLIC WORKS REQUIREMENTS. CONTRACTOR SHALL BE RESPONSIBLE FOR INSTALLING ANY APPURTENANCES ON THE DOMESTIC LINE SUCH AS BACKFLOW PREVENTION DEVICES, GATE VALVES, ETC., WHICH MAY BE REQUIRED. CONTRACTOR TO COORDINATE WITH CITY OF ANY TOWN PUBLIC WORKS DEPARTMENT.
- I 8" SPRINKLER LINE ENTRY. CONTRACTOR SHALL BE REQUIRED TO INSTALL ANY APPURTENANCES ON THE SPRINKLER LINE SUCH AS, BUT NOT LIMITED TO, A DOUBLE DETECTOR CHECK BACKFLOW PREVENTION DEVICE, IN SERIES WITH A CHECK VALVE, GATE VALVES, ETC., MEETING WATER COMPANY SPECIFICATIONS.
- J PROPOSED FIRE HYDRANT AND ASSEMBLY, TYPICAL AS INDICATED. SEE DETAIL SHEET.
- K REMOTE GARDEN CENTER UTILITIES PIPE BOLLARD. - NOT USED

- L ALL LP CAMERA PULL BOXES LOCATED IN PAVED AREAS SUBJECT TO TRUCK TRAFFIC SHALL BE "H-20" LOAD RATED. THE TYPICAL PULL BOX SIZE WILL BE 17" X 30" X 28" "QUAZITE" PG1730BA28 BOX WITH PG1730HHDD LID, OR APPROVED EQUAL. DEEPER BOXES MAY BE REQUIRED WHEN THE CONDUIT ALIGNMENT IS AFFECTED BY OTHER UTILITIES. THE PULL BOX SHALL BE INSTALLED PER THE MANUFACTURER'S SPECIFICATION WITH A CONCRETE COLLAR AND A MINIMUM OF 8" OF GRAVEL COMPACTED PER PROJECT SPECIFICATIONS.
- M ONE 3" DIAMETER CARLON TYPE "DB" DIRECT BURIAL TELEPHONE DUCT OR 3" SCHEDULE 40 PVC. INSTALL GALVANIZED PULL WIRE OR PURPLE PROPYLENE POLYETHYLENE ROPE WITH A MINIMUM PULLING TENSION OF 100 POUNDS. THE MINIMUM BURIAL DEPTH SHALL BE 24". INSTALL AN ORANGE DETECTABLE HAZARD TAPE WITH INTEGRAL "BURIED CABLE" WORDING, 12" ABOVE CONDUIT.
- N ONE 2" CONDUIT SHALL BE CARLON TYPE "DB" DIRECT BURIAL TELEPHONE DUCT OR SCHEDULE 40 PVC. INSTALL GALVANIZED PULL WIRE OR PURPLE PROPYLENE POLYETHYLENE ROPE WITH A MINIMUM PULLING TENSION OF 100 POUNDS. THE MINIMUM BURIAL DEPTH SHALL BE 24". INSTALL AN ORANGE DETECTABLE HAZARD TAPE WITH INTEGRAL "BURIED CABLE" WORDING, 12" ABOVE CONDUIT. THE 2" LP CAMERA CONDUIT SHALL BE SEPARATED FROM THE 480VAC LIGHT FIXTURE POWER BY A DIVIDER PLACED IN THE LIGHT POLE BASE JUNCTION BOX.

- O INDEPENDENT 4" CONDUIT FOR ELECTRIC, 3/4" WATER LINE, AND 4" SANITARY SEWER SUB OUT TO THE PROPOSED KIOSK FOR SAM'S GAS OR AS NECESSARY, COORDINATE WITH DESIGN MANAGER (GEO TO PROVIDE DEDICATED POWER AND WATER FOR SAM'S GAS FOR CARWASH)
- P REMOTE FIRE DEPARTMENT CONNECTION PER CITY OF NEW BERN REQUIREMENTS. CONNECT TO BUILDING WITH 6" FDC LINE, SEE ARCH. PLANS. FIRE HYDRANT SHALL BE LOCATED WITHIN 10' OF FDC.



BEFORE YOU DIG!
CALL 1-800-832-4949
N.C. ONE-CALL CENTER
IT'S THE LAW!

SEE NOTES SHEET
FOR UTILITY NOTES

- LINE LEGEND
- EXISTING PROPERTY BOUNDARY
 - EXISTING LEGAL ROW
 - EXISTING ADJACENT PROPERTY LINE
 - EXISTING TREE LINE
 - PROPOSED TREE LINE
 - EXISTING FENCE
 - EXISTING CURB TO BE REMOVED
 - EXISTING STORM SEWER LINE
 - EXISTING SANITARY SEWER LINE
 - EXISTING TELEPHONE
 - EXISTING OVERHEAD ELECTRIC
 - EXISTING STORM SEWER LINE (TBR)
 - EXISTING SANITARY SEWER LINE
 - PROPOSED RETAINING WALL
 - PROPOSED CURB
 - PROPOSED FLUSH CURB
 - PROPOSED STORM SEWER
 - PROPOSED ELECTRIC LINE
 - PROPOSED TELEPHONE LINE
 - PROPOSED GAS LINE
 - PROPOSED SANITARY LINE
 - PROPOSED WATER LINE
 - PROPOSED UNDERGROUND ELECTRIC & TELEPHONE LINE
- SYMBOL LEGEND
- EXISTING HYDRANT
 - EXISTING TREE
 - EXISTING SANITARY MANHOLE
 - EXISTING STORMWATER INLET
 - EXISTING STORMWATER MANHOLE
 - PROPOSED CLEAN-OUT
 - PROPOSED TYPE 'C' INLET
 - PROPOSED TYPE 'M' INLET
 - PROPOSED PULL BOX
 - PROPOSED A.D.A. RAMP
 - PROPOSED LIGHT FIXTURE(S)
 - PROPOSED UTILITY POLE
 - PROPOSED FIRE HYDRANT
 - PROPOSED SIGN
 - PROPOSED PIPE BOLLARD
 - PROPOSED MANHOLE

SYMBOL LEGEND

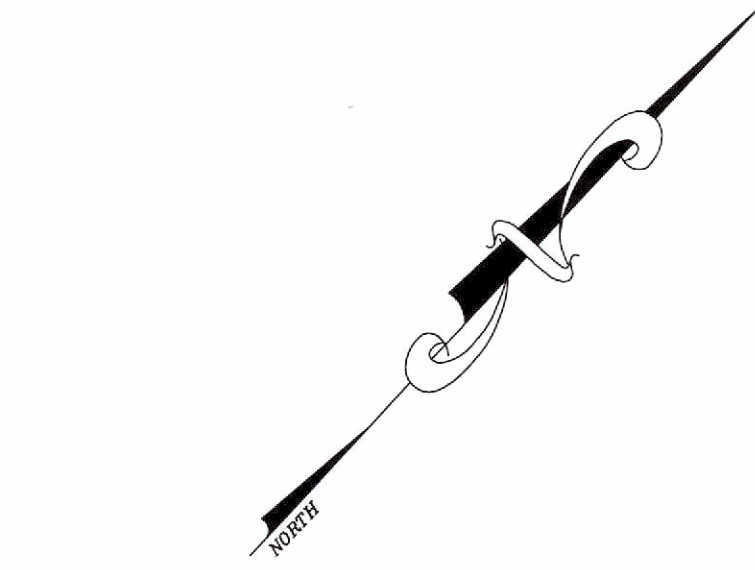

UTILITY PLAN

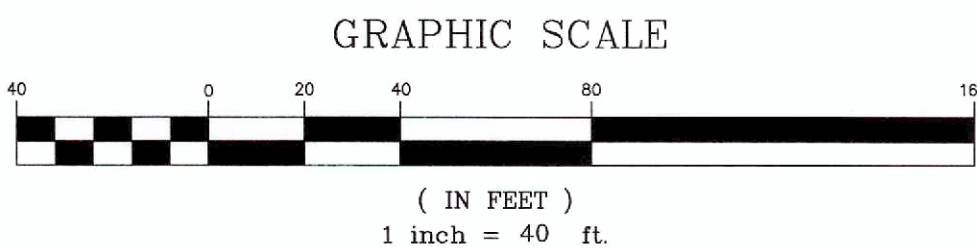

REVISIONS	BY
PER CITY COMMENTS	CWS
PER OUT TO BID	CWS
PER ARCH. COORDINATION	CWS
PER NCDENR COMMENTS	CWS
PER WATER REVISIONS	CWS

BOHLER ENGINEERING

CORPORATE OFFICE:
WARREN, NJ

SURVEYORS
CIVIL & CONSULTING ENGINEERS

PROJECT MANAGERS
ENVIRONMENTAL ENGINEERS
LANDSCAPE ARCHITECTS

SO. BROWARD COUNTY, FL
DADE COUNTY, FL
DIDEL COUNTY, FL
HARRIS COUNTY, TX
HUNTERDON COUNTY, NJ
JACKSONVILLE, FL
KANE COUNTY, IL
KANSAS CITY, MO
LOS ANGELES, CA
MADISON, WI
MILWAUKEE, WI
MINNEAPOLIS, MN
MISSISSAUGA, ONT.
NEW YORK, NY
OKLAHOMA CITY, OK
PORTLAND, OR
SAN ANTONIO, TX
SAN JOSE, CA
SEATTLE, WA
SPRINGFIELD, IL
TAMPA, FL
TULSA, OK
WASHINGTON, DC
WICHITA, KS
WISCONSIN, WI
WYOMING, WY



NEIGHBORHOOD MARKET #7218-00
2915 NEUSE BOULEVARD
CITY OF NEW BERN, CRAVEN COUNTY, NC
WAL-MART STORES EAST, L.P.
2001 SE 10TH STREET
BENTONVILLE, AR 72716



DRAWN	J.H.H.
CHECKED	J.R.H.
DATE	09/09/13
SCALE	AS NOTED
JOB No.	NCC138113
SHEET	